

N-640/840 Air Spring Replacement

Required Tools

1. Phillips head screwdriver (Size #1)
2. 3/4" Open End Wrench
3. 3/4" Socket with Ratchet
4. 5/16" Allen Wrench
5. 9/16" Open End Wrench
6. Plumber's Teflon thread tape

Symptom- Tire Blow-out or Audible Air leak from tire.

WARNING: BEFORE MAKING REPAIRS, BE SURE ON/OFF SWITCH IS OFF, AIR SUPPLY IS OFF AND MACHINE IS UNPLUGGED !

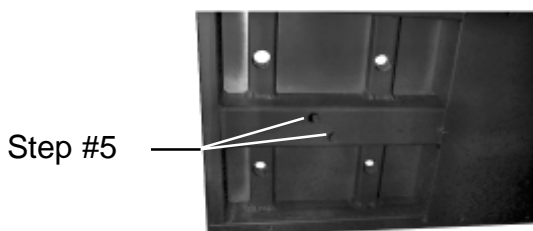
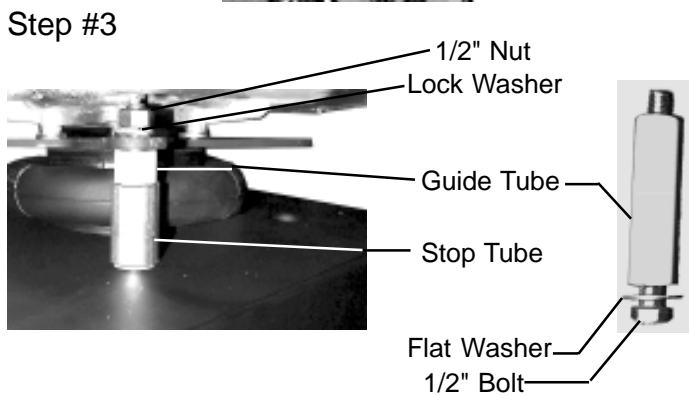
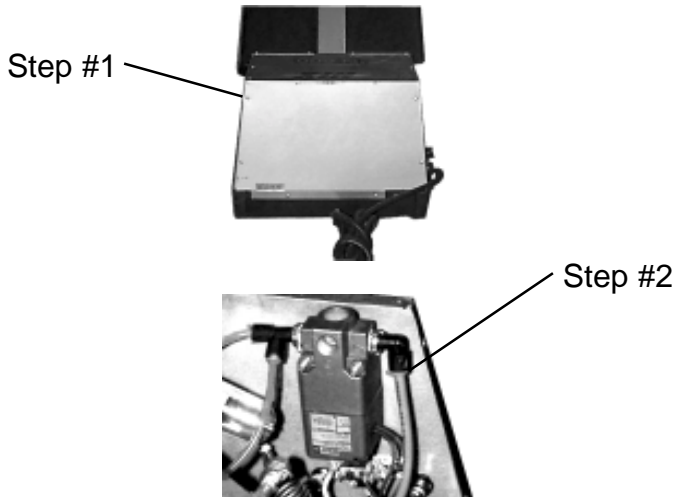

1. Using a Size #1 Phillips head screwdriver remove the back access panel of the housing.
2. From the back of the machine locate the Solenoid Valve (shown left). Gently slide the red ring indicated up toward the solenoid valve, pull down on the nylon tub while holding the red ring up.
3. From the front of the machine, look under the lower platen. Locate the (4) four guide tube assemblies at each of the four corners. Using a 3/4" Open end Wrench and a 3/4" socket remove the center bolt from each guide post assembly. The bolt pulls out from the bottom of the machine. Layout the assembly as it is removed so that each piece can be replaced in order.
4. Remove the lower platen and set aside.
5. Carefully tip machine up on one side and locate the (2) two access holes for the tire attachment. Using a 5/16" Allen wrench remove the two screws through the access holes. Let machine back down carefully.
6. Carefully wiggle the tire elbow (located under the tire) out of the hole. Repeat procedure from Step #2 to remove the tube from the elbow. Using a 9/16" open end wrench remove elbow from existing tire to be replaced on to the new tire



View of underside of tire

7. Clean the teflon plumbers tape off the removed elbow. Replace new plumbers teflon tape around the threads of the existing elbow and use the 9/16" Open end wrench to place the existing elbw into the new air spring (tire).
8. Reconnect the air tube into the elbow by holding the red ring up and sliding the tube in; gently slide the red ring down while holding the tube in will lock the tube into place.
9. Replace the new air spring onto the machine base with the (2) two black 5/16" Allen bolts.
10. Replace the lower platen on to the Air spring using Step #3 as a guide. Tighten the bolt and nut with the 3/4" open end wrench and the 3/4" socket and ratchet.
11. From the back of the machine reconnect the nylon tube to the solenoid valve by repeating Step #8.
12. Replace the back access panel. Plug in the machine and the air suupply. The machine is now ready for operation.